

| | | |
|---------------------------------|---|------------------------------------|
| Doc # MA-A090625-D001 | FITTING INSTRUCTIONS | Revision: 0 |
| | BMW R1200GS/R1200GS Adventure LC K50 K51 Wide Rider Foot Pegs (Pair) | Date: 2017-06-28 ENGLISH |

A qualified, experienced motorcycle or vehicle technician should install Motorradical 3DX products. If you are unsure of your ability to properly install a product, please have the product installed by your local motorcycle dealer. Motorradical takes no responsibility for damages caused by improper installation. All screws, bolts and nuts, including all replacement hardware provided by Motorradical, should be tightened to the torque specified in the OEM maintenance manual for your motorcycle. If no torque specifications are provided in the OEM maintenance manual, a Torque Chart is available on our website. All screws, bolts and nuts should be checked after driving the first 50 km to ensure that all are tightened to the proper torque. Medium strength liquid thread-locker (i.e., "Locktite") should be used to secure all screws bolts and nuts.

| | |
|------------------------------|---|
| Packaging Weight: | 0.530 kg |
| Packaging Dimensions: | 200mm (L) x 260mm (W) x 50mm (H) |

KIT CONTENTS:

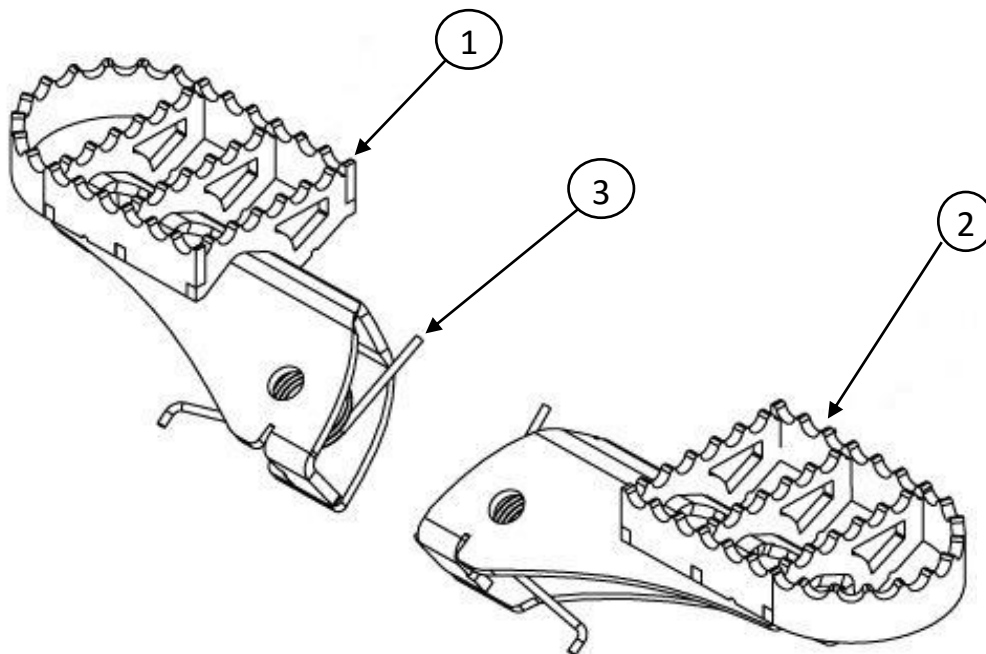

Parts List

| No. | Description | Part Number | QTY |
|-----|----------------------------------|---------------|-----|
| 1 | BMW1200GSA Wide Foot Peg LH Assy | SA-A09062501 | 1 |
| 2 | BMW1200GSA Wide Foot Peg RH Assy | SA-A09062503 | 1 |
| 3 | Torsion SPA ID17mm x 2.0mm | WENG-SPR-1045 | 2 |

TOOLS REQUIRED

- Flat Screwdriver
- Pliers

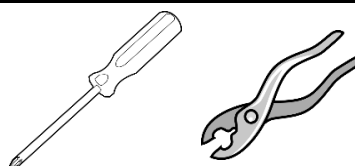

Install Time
10 min

Preparation:

Read the instruction carefully before installation. Ensure that all parts listed in this document are included in the package.
Park the vehicle on a level hard surface in a sufficiently lit and ventilated work environment. Use only appropriate tools and equipment.
Disconnect the battery whenever working on the electrical system.

Installation:

Reconnect all connectors, clips and parts removed during the installation in accordance with the vehicle manufacturer specification
Secure all threads, unless otherwise specified with medium-strong liquid thread locker. Tighten all fasteners in accordance with the vehicle specification and / or according to DIN/ISO specification.
Replace all parts and hardware removed for installation according the vehicle specifications.

Functionality Check:

Once the installation is complete, ensure that no moving parts, wire or fuel hoses are pinched or obstructed in any way. Ensure the normal functionality of the vehicle. Attach and secure all cables and connectors correctly.

General:

If required register installed accessories in the vehicle document with appropriate authorities.

Disclaimer:

Instructions are set out as accurately as possible. There are currently no legal requirements for correctness. Technical issues may vary and are subject to change. Brightwing Technologies or any of its subsidiaries will not be liable for any damages, direct or indirect, that may arise from fitting accessories. For more see www.motorradical.co.za.

TORQUE CHART

| | | | | | | | | |
|---|--|-----|-----|-----|-----|------|----|----|
| A2 or A4 Stainless Steel | Lubricated (N-m) | 0.9 | 2.3 | 4.6 | 7.8 | 19.1 | 38 | 66 |
| | Dry (N-m) | 1 | 2.6 | 5.1 | 8.7 | 21.2 | 42 | 73 |
| Property Class | Bolt ϕ (mm) | 3 | 4 | 5 | 6 | 8 | 10 | 12 |

MOUNTING

1. Remove the Circlip beneath the LHS OE Foot Peg and remove the Pin.



2. Once the OE Foot Peg is removed the Foot Peg and Spring can be discarded.



NOTE: DO NOT DISCARD SPACER , PIN AND CIRCLIP.



3. Insert the OE Spacer into the round cavity of the provided Spring (item 3) and place it in the Wide Foot Peg LH Assy (item 1) in the indicated orientation.



4. Place the Wide Foot Peg into the Foot Peg Mounts as indicated and replace the Pin removed in Step 1.



5. Replace the Circlip removed in Step 1.



6. Repeat Step 1 - 5 for the RHS Wide Foot Peg installation.

